

WFB Wound Ferrite Beads

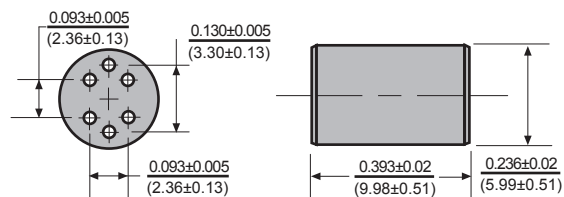

Dimensions: $\frac{\text{Inches}}{\text{(mm)}}$

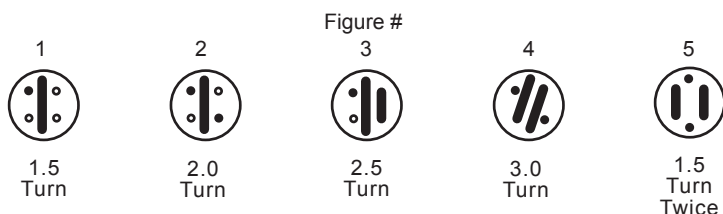
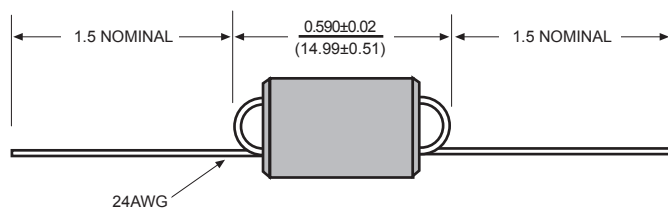
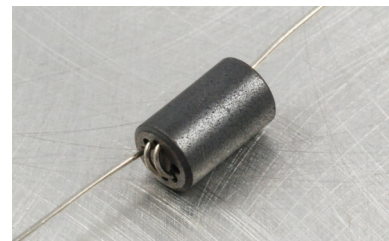

The **WFB Series** Wide Band Chokes are 6 hole, ferrite beads with 1.5, 2.0, 2.5, 2 x 1.5 or 3.0 turns of tinned copper wire. They are ideal for interference suppression in a variety of applications where broad band characteristics are required.

Wide Band Chokes are essentially resistive with flat impedance matching characteristics above 60 MHz. When used with small ceramic capacitors, self resonance provides additional attenuation.

| Allied Part Number | Core Material | Number of Turns | Impedance Ohms | Frequency (MHz) | Fig # |
|----------------------|---------------|-----------------|----------------|-----------------|-------|
| WFB-1.5-281-1-RC | 1 | 1 1/2 | 280 | 120 | 1 |
| WFB-1.5-301-2-RC | 2 | 1 1/2 | 300 | 180 | 1 |
| WFB-1.5-361-3-RC | 3 | 1 1/2 | 360 | 250 | 1 |
| WFB-2.0-401-1-RC | 1 | 2.0 | 400 | 50 | 2 |
| WFB-2.0-481-2-RC | 2 | 2.0 | 480 | 100 | 2 |
| WFB-2.0-601-3-RC | 3 | 2.0 | 600 | 180 | 2 |
| WFB-2.5-601-1-RC | 1 | 2 1/2 | 600 | 50 | 3 |
| WFB-2.5-601-2-RC | 2 | 2 1/2 | 600 | 100 | 3 |
| WFB-2.5-681-3-RC | 3 | 2 1/2 | 680 | 180 | 3 |
| WFB-3.0-681-1-RC | 1 | 3.0 | 680 | 50 | 4 |
| WFB-3.0-681-2-RC | 2 | 3.0 | 680 | 100 | 4 |
| WFB-3.0-601-3-RC | 3 | 3.0 | 600 | 180 | 4 |
| WFB-2 x 1.5-601-1-RC | 1 | 2 x 1 1/2 | 600* | 50 | 5 |
| WFB-2 x 1.5-601-2-RC | 2 | 2 x 1 1/2 | 600* | 100 | 5 |
| WFB-2 x 1.5-561-3-RC | 3 | 2 x 1 1/2 | 560* | 180 | 5 |

*Measured with the two 1 1/2 turn windings in series. All specifications subject to change without notice.

www.DataSheet4U.com

Physical

Packaging: 500 pieces per bag.

8000 pieces per box.